

# Nintendo Switch Instructions

Nintendo Switch must be factory reset  
before returning

## Setup and Connection

1. Connect the AC adapter to the system.

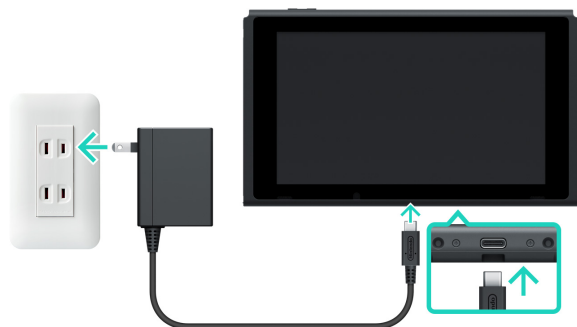

-Connect the USB plug from the Nintendo Switch AC adapter into the USB connector on the bottom of the console, then connect the AC adapter into the wall outlet.

-The system will power on after you connect the AC adapter provided.

2. Attach the Joy-Con controllers to the Nintendo Switch console.



3. Follow the on-screen prompts to complete the first-time setup.  
-Some of the settings can be configured later.

1. Select the system language and region settings.

2. View the End User License Agreement (EULA). By selecting Accept, you acknowledge that you have read and agree to be bound by the End-User License Agreement. If you do not agree, stop using this system.

3. Configure Internet Settings (optional).  
-Press X to configure these settings later.

4. Select your Time Zone.

5. Set your icon and nickname, or Transfer Users and Save Data\*\*.

\*\*This option is available for consoles with system menu version 4.0.0. or higher.

6. Configure Parental Controls (optional).

-If desired, you can configure Parental Controls at a later time. Press Skip to complete the first time setup.

### **Detaching Joy-Con Controllers**

Press the release button at the back of the Joy-Con while sliding the Joy-Con from bottom to top.

#### **Important:**

After detaching the Joy-Con controllers from the console, be sure to attach the Joy-Con straps before starting a game or software.

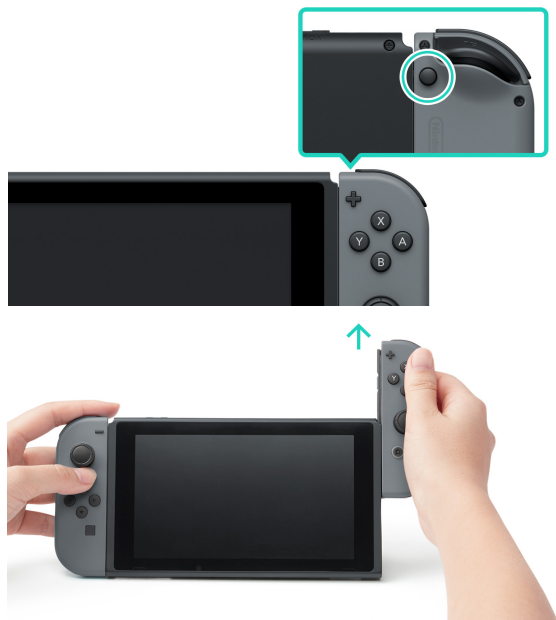

## Factory Reset

On the Home screen, go to the “System Settings” menu on the bottom of the screen — it’s the icon that looks like a gear. Hit the “A” button and you’ll see a list of options running down the left side of the screen. You want the bottom-most option, labeled “System.”

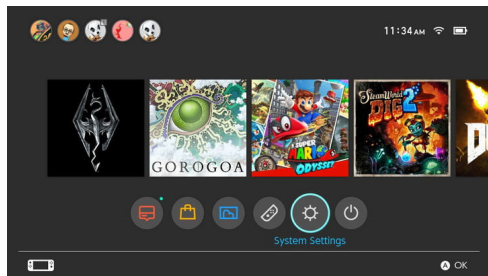

The System menu options will appear on the right side of the screen. You need to scroll down again to the bottom option, “Initialize.” There is a small exclamation point icon next to the Initialize option, warning you that this is a drastic, can’t-be-undone action. Hit the “A” button again and you will bring up the “Initialize” menu, which has a number of options for wiping and resetting the console.

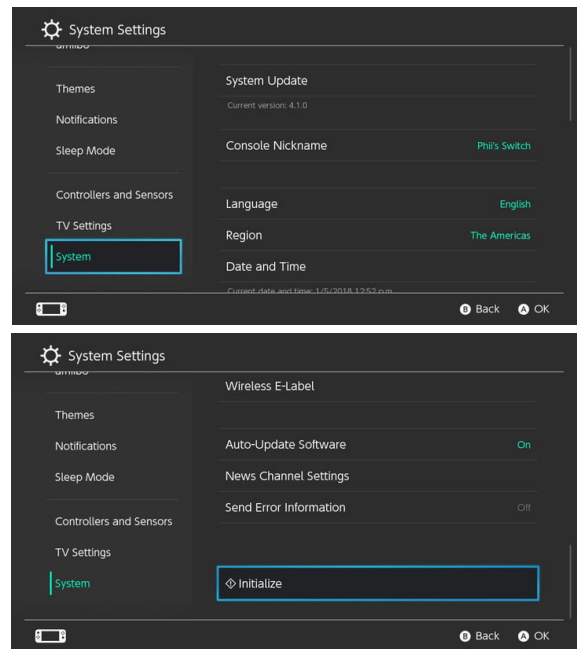

### Select Initialize Console

This will delete all saved data, screenshots, videos, user accounts, web browser data, game data, and system updates. It will also reset system settings like parental controls to their defaults. If you have a Nintendo

user account linked to online services like the Nintendo eShop, the account will still exist online, but it will no longer be linked to the Switch. According to Nintendo, any data from the Switch you stored on a microSD card won't be deleted. Aside from your screenshots and videos, though, the data on your microSD card will become unusable.

