

Cricut Easy Press 2 Instructions

Countdown timer
Beeps when iron-on transfer is complete

Precise digital controls
Easy to set exact temperature and time

Comfortable handle
Safe and easy to grip during use

9" x 9" evenly heated plate
Dry, even heat means flawless transfers

Safety Base
Insulated base keeps Cricut EasyPress™ in a protected, resting position

Auto shutoff
Shuts off automatically after 10 minutes



Press Temp button, then adjust value with plus (+) and minus (-) buttons. To switch from Fahrenheit to Celsius, press and hold the Temp button.

Orange light means it's heating up.
Green light means temperature has been reached.

Set time
Press Timer button, then adjust value with plus (+) and minus (-) buttons.

Start timer
Press the Cricut C button to start the countdown.
A beep signals time is up.



Make it last

Maximize the life of your iron-on projects wash after wash with these suggestions.

Before iron-on application

For awesome results, always pre-wash and thoroughly dry your fabrics. When washing, do not use fabric softener. If you have no time for washing, you'll still get pretty great results.

During iron-on application

Just before transfer, preheat your base fabric for 3-5 seconds to remove wrinkles and moisture. After adhering your design, flip your fabric and repeat on the other side. Use the same settings.

After iron-on application

Wait at least 24 hours before washing. Always wash inside-out. Do not bleach. Wash only in cool water, then tumble dry low or lay flat to dry. For foil iron-ons, hand-wash in cold water only.

Get more great tips and suggestions at help.cricut.com/easypress.



Instructions

We'll take on a T-shirt in the following steps, but you can apply these instructions to anything your heart desires, from a purse to a pillowcase ... to a wedding dress? (Yes, it's been done!)

We want to see the projects you've made using Cricut EasyPress. Share your iron-on creations using #CricutMade & #CricutEasyPress.

Caution: It may be easy, but it's also HOT. Handle EasyPress with care.



1

Get prepped

Power on Cricut EasyPress. Find a firm, flat, heat-resistant surface around waist height. We recommend that you use Cricut EasyPress Mat (pictured, sold separately) as your foundation. Just be sure to avoid flimsy, padded ironing boards.

2

Set time and temperature

Use the Quick Reference Chart to determine the settings for your project. The beep signals Cricut EasyPress is ready to use.





3

Preheat mat and base material

Place Cricut EasyPress on your fabric for 3 – 5 seconds to remove wrinkles and moisture.

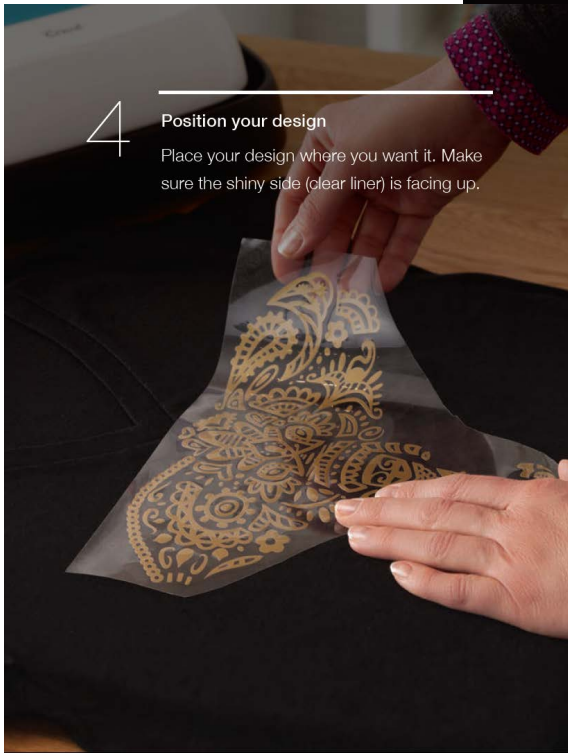

4

Position your design

Place your design where you want it. Make sure the shiny side (clear liner) is facing up.



5

Apply heat on both sides

Place Cricut EasyPress on your design. Start the timer. Hold Cricut EasyPress in place and apply gentle pressure until it beeps. Flip the T-shirt and apply heat on the back side of the design for 10 – 15 seconds.

6

Wait ... before the big reveal!

Let the iron-on film cool completely before you test a corner. If the liner does not lift easily, reapply and reheat a few more seconds. Woo-hoo, that's it!





The Cricut Advantage™

Crafting with iron-on is part art and part science. We've given you a basic foundation to create iron-on projects that truly last. When you're ready for advanced projects we'll be here for you then, too. On the next few pages are ideas designed to inspire your imagination.

- For the most magnificent results, use Cricut EasyPress with Cricut brand iron-on film. We don't just suggest "average" temperature and time settings for any old heat press on any random fabric. We give you precise and rigorously tested settings for the very press that is now in your hand. Use our Quick Reference Chart to make every project perfect.
- Because each iron-on type has unique properties, you'll be amazed at all the possibilities when you learn the nuances of a fabulous foil, gorgeous glitter, or majestic metallic. We'll always share our insights, along with our best pro tips, at help.cricut.com/easypress.

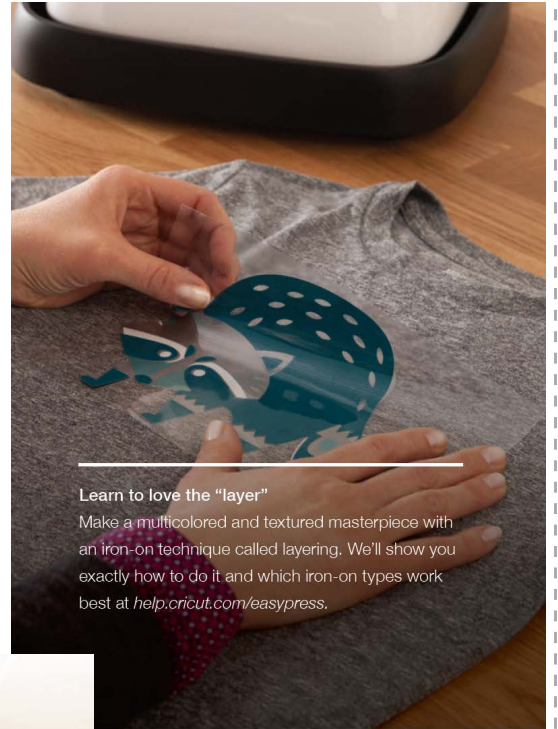

Learn to love the "layer"

Make a multicolored and textured masterpiece with an iron-on technique called layering. We'll show you exactly how to do it and which iron-on types work best at help.cricut.com/easypress.

Yes, you can go big

Indeed, you can have huge success with a large iron-on design! Get our step-by-step instructions on how to tackle your most ambitious ideas at help.cricut.com/easypress.

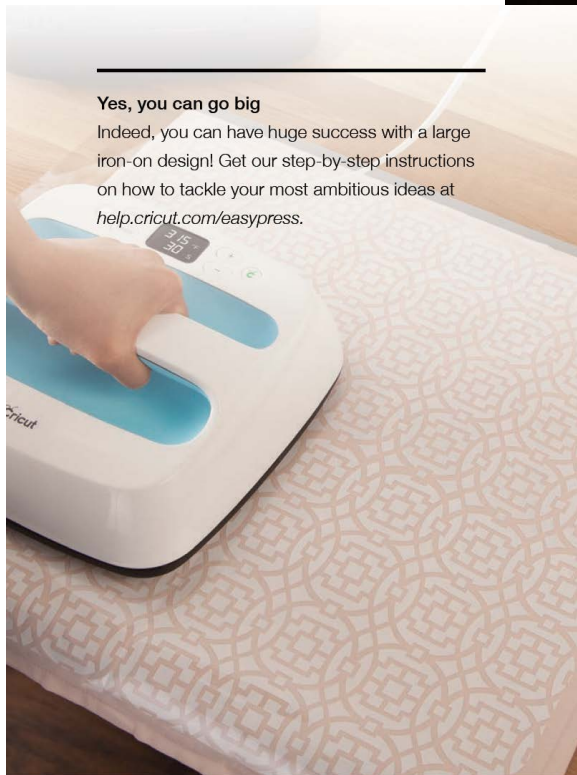

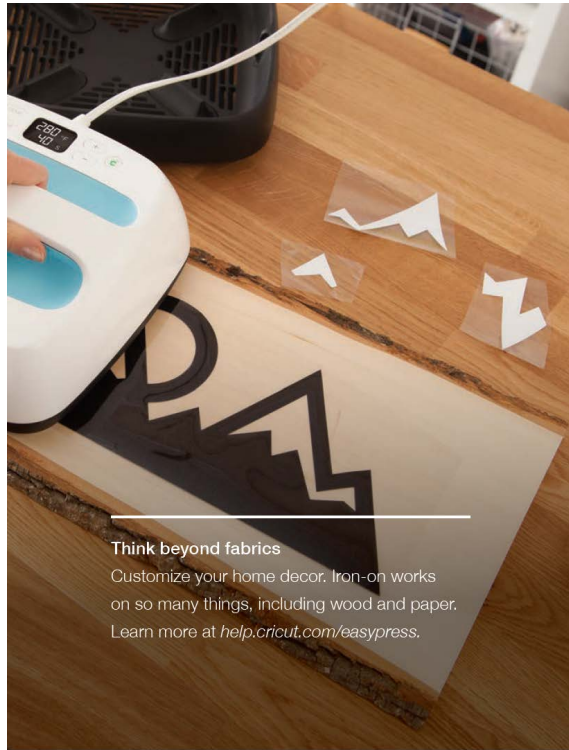

Think beyond fabrics

Customize your home decor. Iron-on works on so many things, including wood and paper. Learn more at help.cricut.com/easypress.



It's not always what it "seams"

We have a simple strategy to get around pesky seams to keep your fabric and design flat for a perfect press. Learn how at help.cricut.com/easypress.

Cut your own designs

The real fun starts when you cut your own iron-on designs using your Cricut cutting machine and Design Space® software.

Before cutting, always mirror (reverse) your design.

If your image includes text or is asymmetrical, you must mirror it in Design Space before you cut. Otherwise, once it's transferred, your design will appear backward.

When cutting, remember this: shiny side faces down.

When using your Cricut machine to cut a design from iron-on film, the clear liner (shiny side) always sticks to your cutting mat.

Cricut machines and Cricut EasyPress are optimized for Cricut iron-on films.

When you select your iron-on type, your Cricut machine automatically adjusts for cut depth.

When you use Cricut brand iron-on film, you'll get the perfect cut and a perfect press every time.

Visit shop.cricut.com.

Time and temperature chart

Use this chart (or the Quick Reference Chart) to determine the perfect time and temperature settings for your project. For a complete list of Cricut EasyPress settings go to help.cricut.com/easypress.

Iron-on type	Base material						
	100% Cotton	Cotton / poly blend	Polyester	Nylon blend or silk	Cotton canvas	Burlap	Felt
Foil	295°F / 145°C 35 sec	285°F / 140°C 30 sec	265°F / 130°C 30 sec	255°F / 125°C 30 sec	270°F / 130°C 40 sec	305°F / 150°C 30 sec	275°F / 135°C 20 sec
Lite / Metallic	305°F / 150°C 30 sec	305°F / 150°C 20 sec	285°F / 140°C 15 sec	265°F / 130°C 30 sec	270°F / 130°C 40 sec	305°F / 150°C 30 sec	275°F / 135°C 20 sec
Glitter	340°F / 170°C 20 sec	320°F / 160°C 15 sec	285°F / 140°C 20 sec	275°F / 135°C 20 sec	270°F / 130°C 40 sec	305°F / 150°C 30 sec	285°F / 140°C 20 sec
Holographic	330°F / 165°C 20 sec	330°F / 165°C 30 sec	285°F / 140°C 30 sec	275°F / 135°C 20 sec	275°F / 135°C 40 sec	305°F / 150°C 30 sec	285°F / 140°C 20 sec



Useful Links

help.cricut.com

Answers to all your Cricut questions

youtube.com/officialcricut

Instructional videos, news, and more

learn.cricut.com

Educational videos, instruction manuals,
and other learning materials

facebook.com/officialcricut

Join the discussion and connect with
the Cricut community

cricut.com/blog

News, announcements, tips, and inspiration

cricut.com/contact-us

Live chat and email support